

# User Instructions

## Power On/Off

Use the power switch at the back to turn on and off the mains power. When turned on, the device will remain in stand-by mode until activated by the front switch or the trigger input.

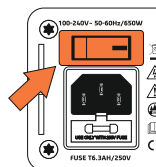

## Front Switch

The front switch can be used to turn-on and turn-off (standby) the power amplifier when the 12 Volt trigger option is not used (when used, the 12V trigger overrules the front switch).

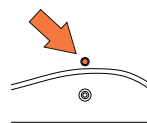

## 12V Trigger

This 3.5mm mini-jack connection allows you to create a network between all of your Hypex Direct amplifiers for a more seamless power up and standby experience. When the amplifiers are in standby mode and you turn on the preamplifier, the connected devices will turn on automatically.

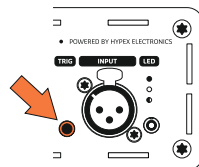

## LED Switch

Adjust the brightness of the power indicator light at the front:

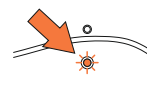
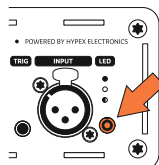

## Input Gain Jumper

The Amplifier Module contains a pinheader with jumper (J200) to alter the input gain setting:

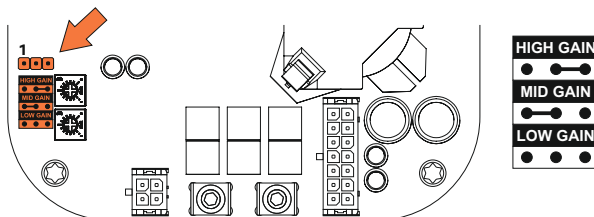

Position	Function		Remarks
Open	Low gain	11.8 dB	Overall gain is set to 11.8dB (3.9x)
1 - 2	Mid gain	21.8 dB	Overall gain is set to 21.8dB (12.3x)
2 - 3	High gain	27.8 dB	Overall gain is set to 27.8dB (24.5x)